

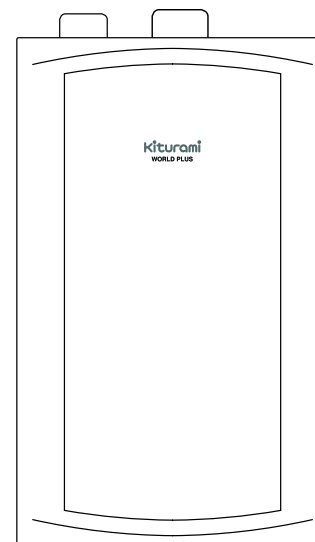

CE PG M K ISO 9001 ISO 14001  
KS

Kiturami

Kiturami



# WORLDPLUS

• WORLDPLUS – 13 / 16 / 20 / 25 / 30

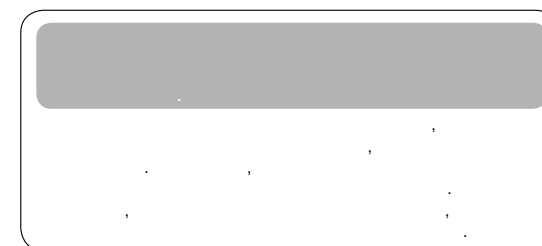

Boiler-Gas.ru  
Перейти на сайт



« »

- |     |     |    |
|-----|-----|----|
| 1.  |     | 03 |
| 2.  | « » | 04 |
| 3.  |     | 05 |
| 4.  |     | 08 |
| 5.  |     | 11 |
| 6.  |     | 18 |
| 7.  |     | 22 |
| 8.  |     | 23 |
| 9.  |     | 24 |
| 10. |     | 26 |
| 11. |     | 27 |
| 12. |     | 29 |
| 13. |     | 41 |
| 14. |     | 42 |
| 15. |     | 43 |

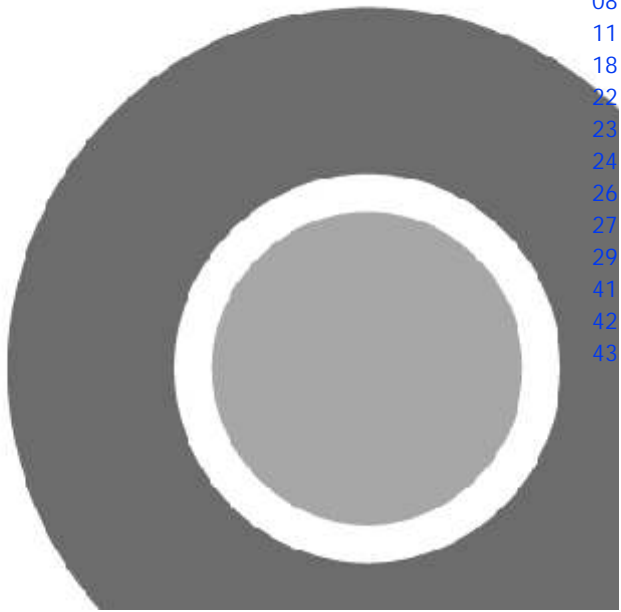

Kiturami

?

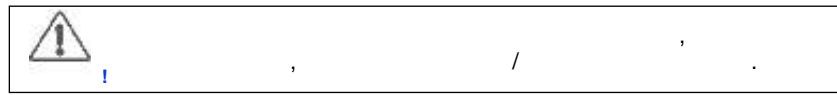

« !», « », « !», :



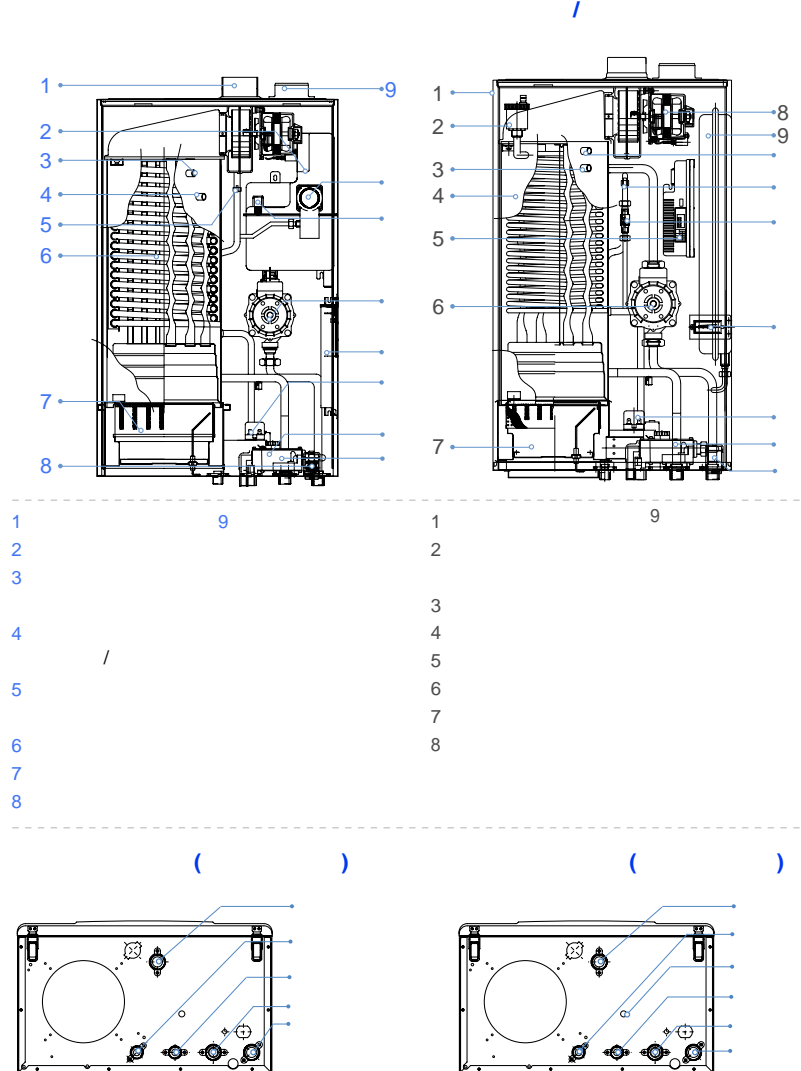



Kiturami

(GTX\_5050N)

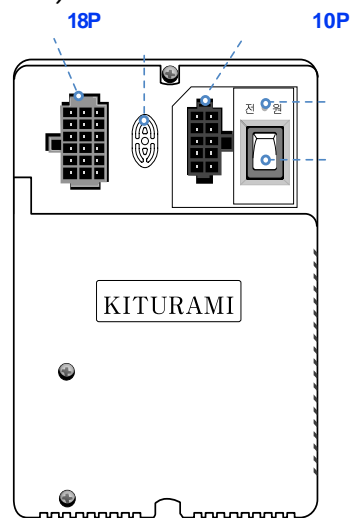
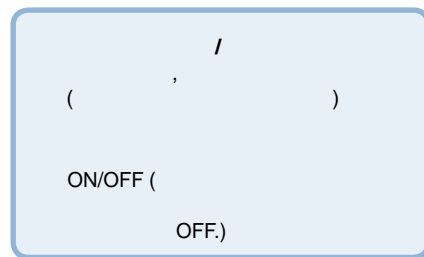

-

(GTX\_6000)

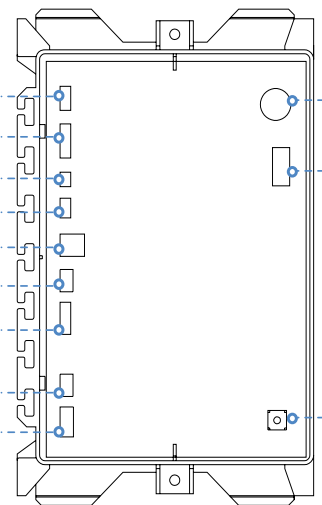
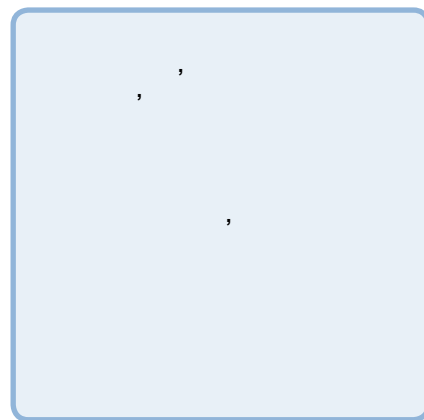

Kiturami

CTR-5700 PLUS

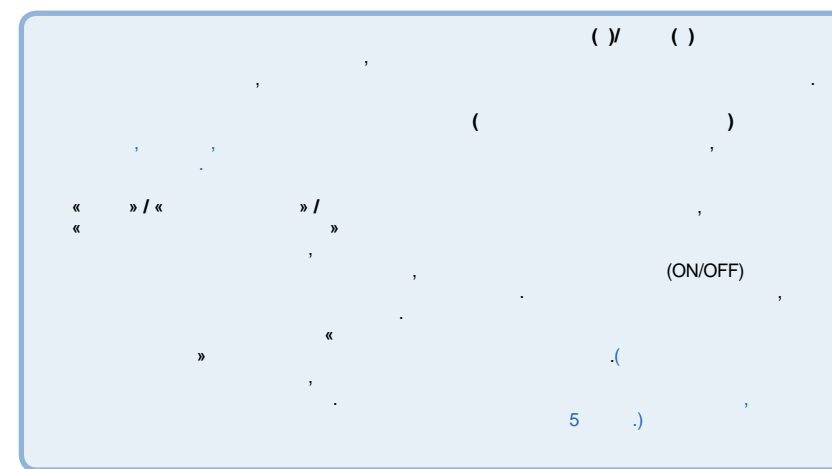
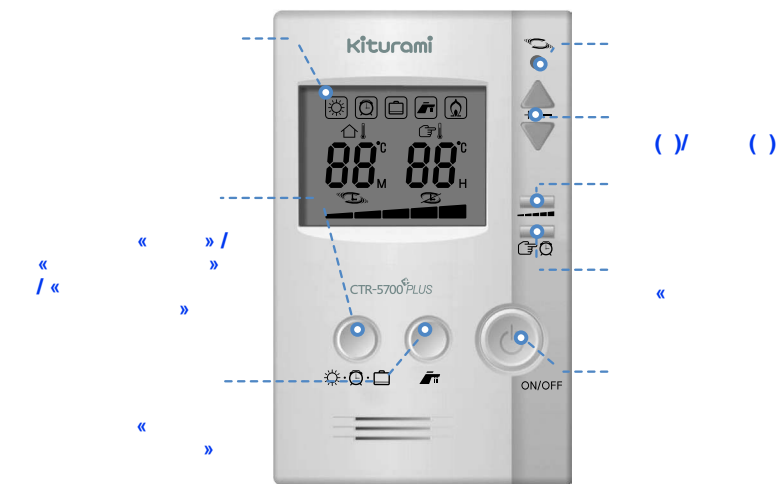



Kiturami



:

( . )



:

230 /50

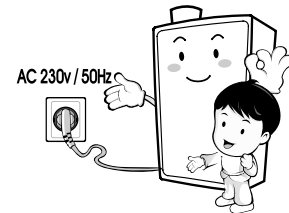

:

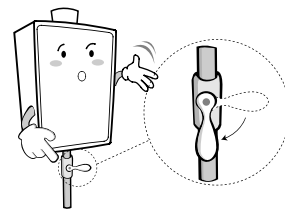

Kiturami



:

No. 95

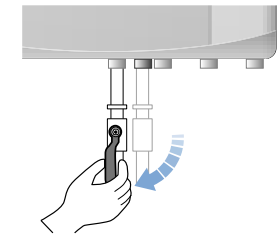

:

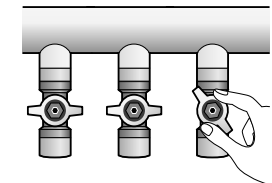

:

(CO).

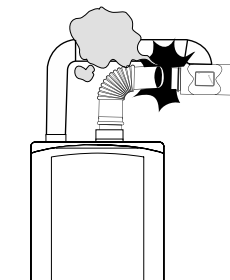

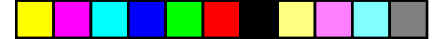

!



30°C.)



!

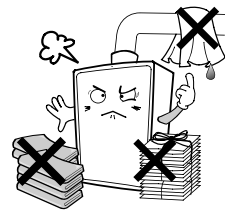

:

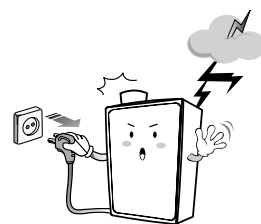

!



:



!



:

- 1.
- 2.
- 3.

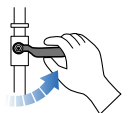
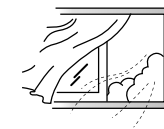

?



!



:



(

?

'97'



:

. ( . . 20)



:

“95”



:

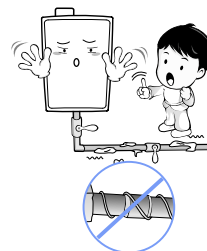

1.

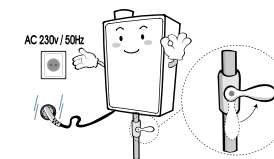

2.

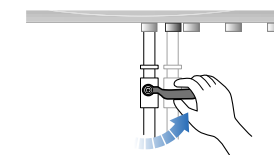

3.

4.

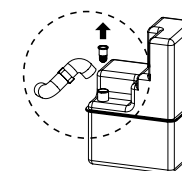

5.

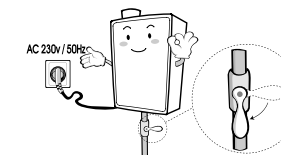



:

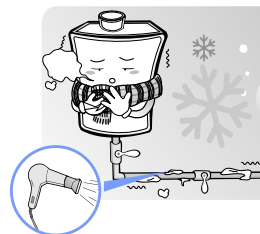

?



:

:

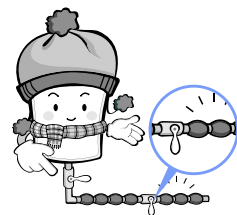

:



:

2-3

2-3

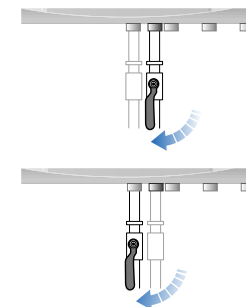

:

?

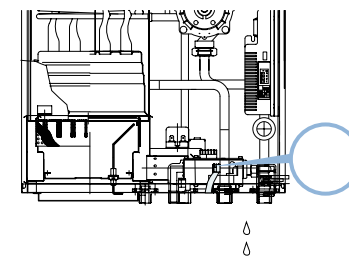

!

:

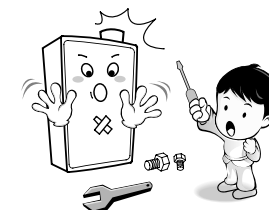





!

: 1



!



:

: 2

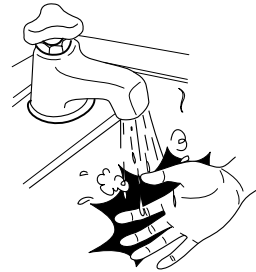

:

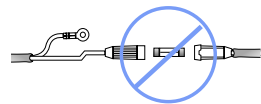

:

1-2

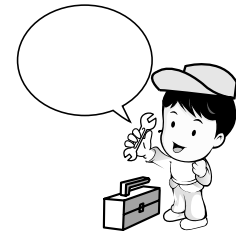

:

(

)

),

(

(2kgf/cm<sup>2</sup>)

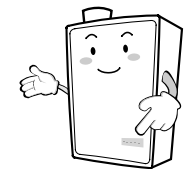



« » (CTR – 5700PLUS)

1. « »,  
(  
.  
.)

2. ( ) / ( ).

3. ( < < < < < )

?

« » « ».

1. « »,  
(  
:  
, 20 2 20  
( ) /

1.  
2. ON  
( ) OFF ( )

3. ( ) ( ) / ( )

4. ,

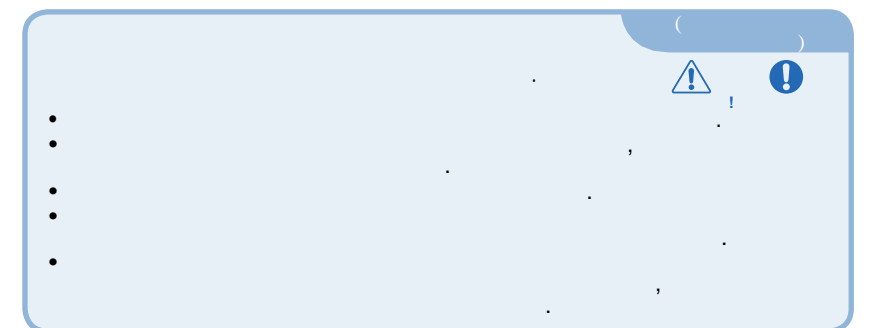
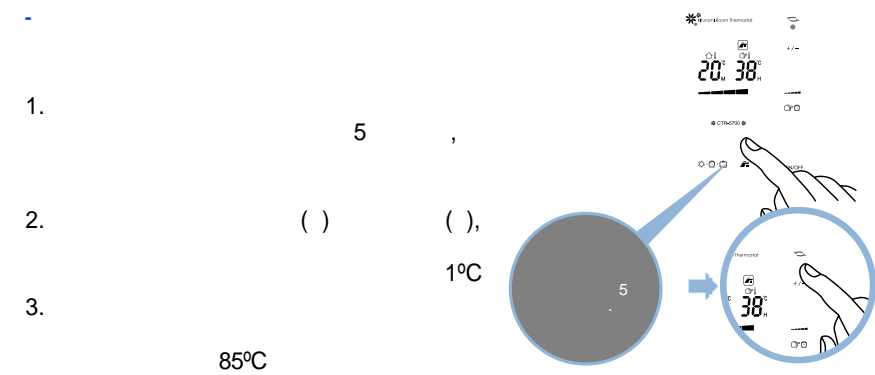
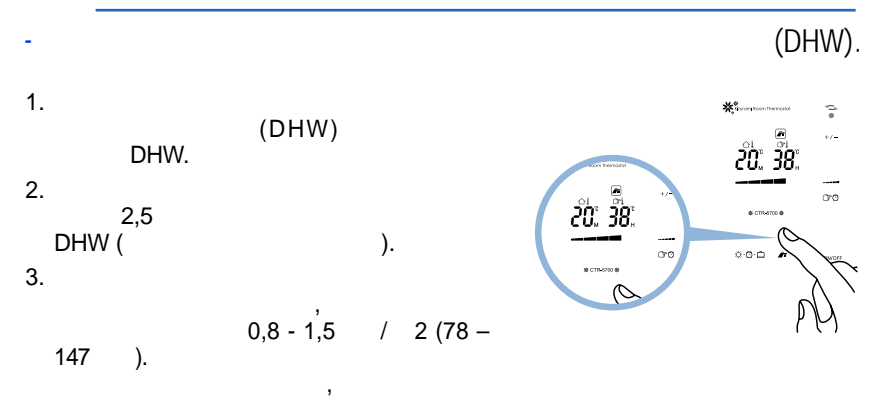
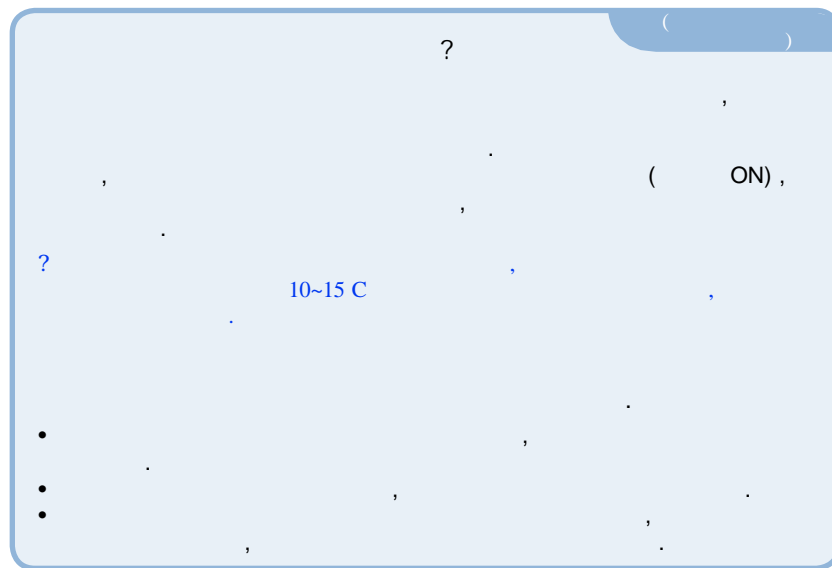
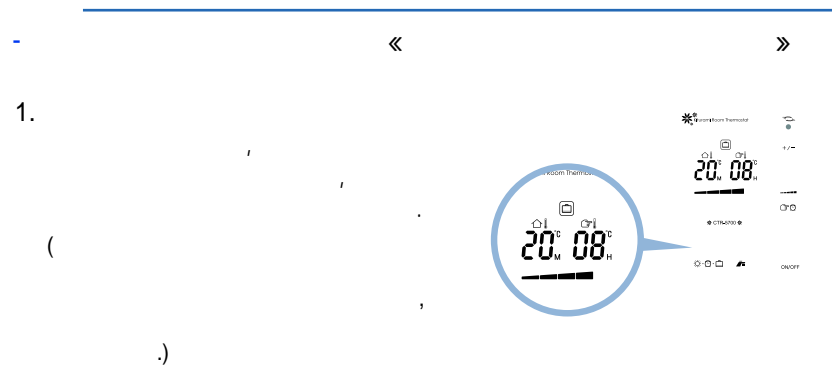



Kiturami



Kiturami

2-3

( , .)





Kiturami



5 ( )



Kiturami

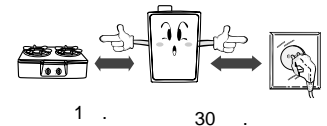
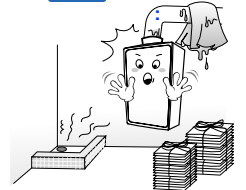
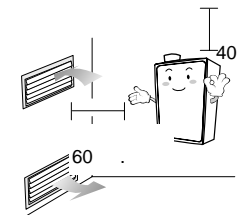



Kiturami



:

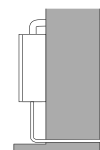

31æ1è°ü°`Ù

3.Ä°°÷¿i ¼³Äi ±ÝÄö



:

°Ö¿¬¼° °®¿i ¼³Äi

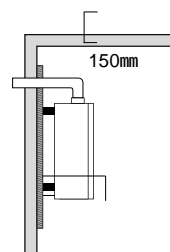

3



:

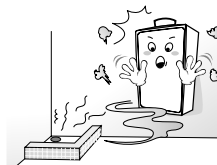

:



¿¬¼°Ö±â±ÜÄ³¼³Äi±ÝÄö



Kiturami

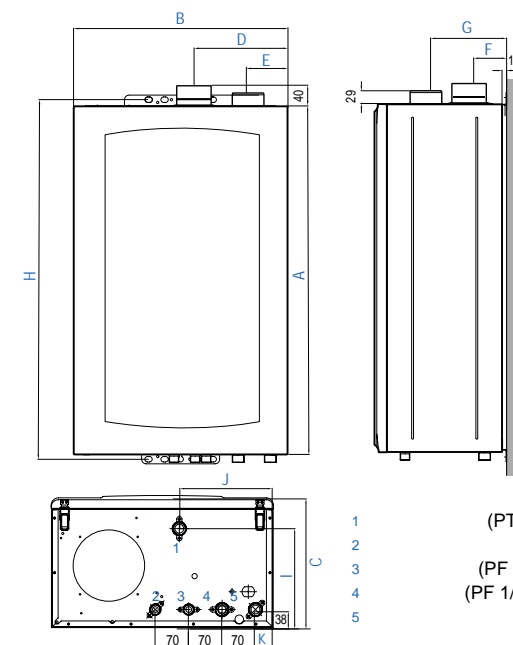

[ 10 ~ 30 ]

房種	A	B	C	D	E	F	G	H	I	J	K
10, 13	720	430	232	197.9	86.4	75.6	147.6	746	181.5	215	26
16, 20	761	465	278	203.5	101	81.8	175.8	786	202.9	222.8	37
25, 30	787	505	305	203.8	109.6	97.4	208.9	813	227.7	272.6	37

35 ~ 45



-(FF)  
/

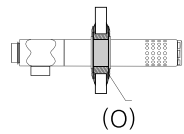
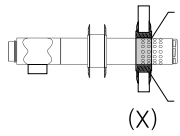
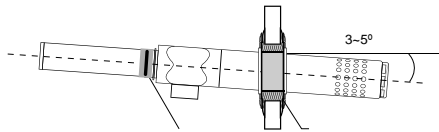
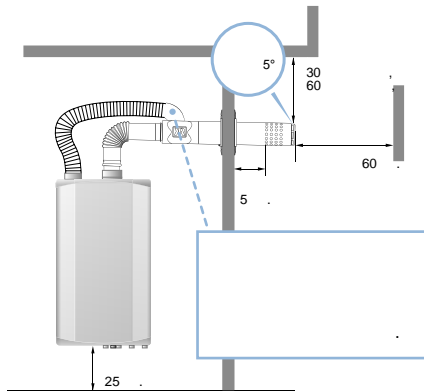

?

( FE)

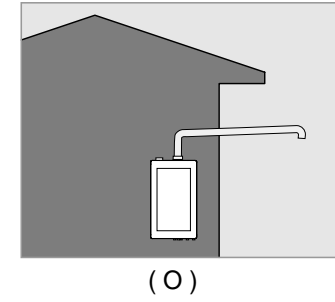
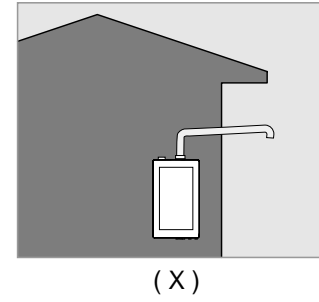

( )

FE,







(FE)  
FE (Forced Exhaust – )

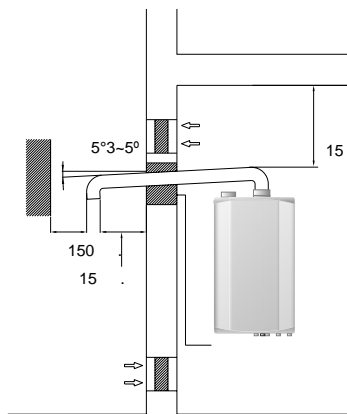

5°

1,6

60

2

= 60

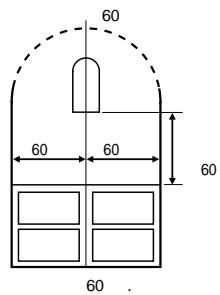

FE

5

3

90°

(CO).

2



•

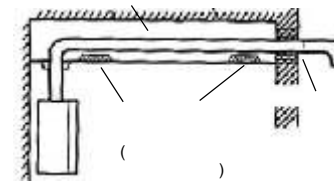

( )

•

( )

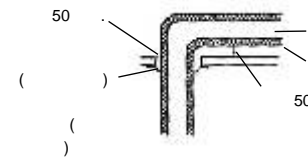

90

20



Kiturami



230 /50

230

230

230

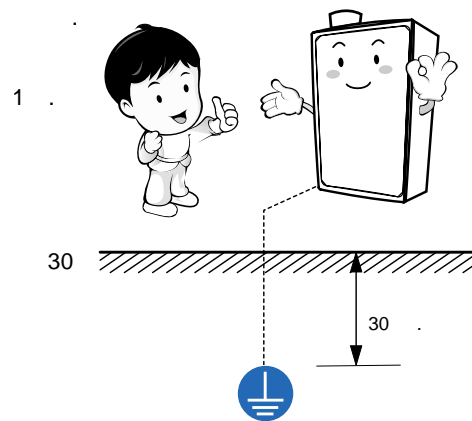

30

30

30



Kiturami



15A (PT 1/2).

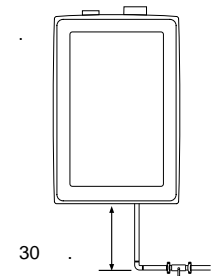

30

30

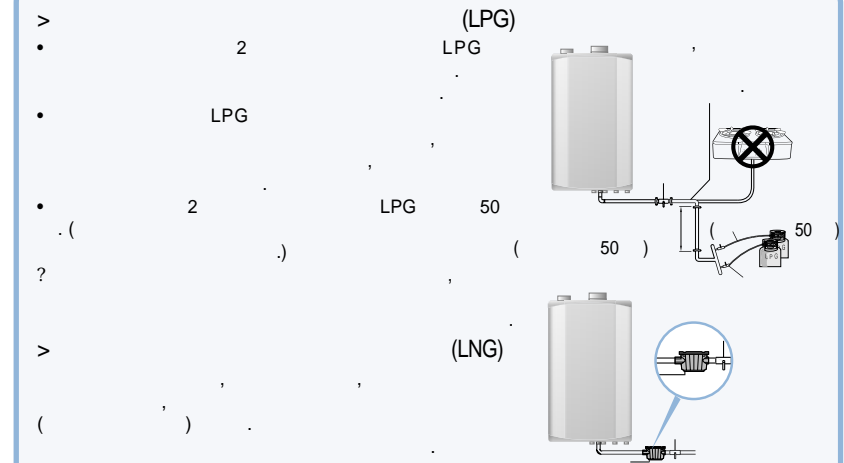



Kiturami

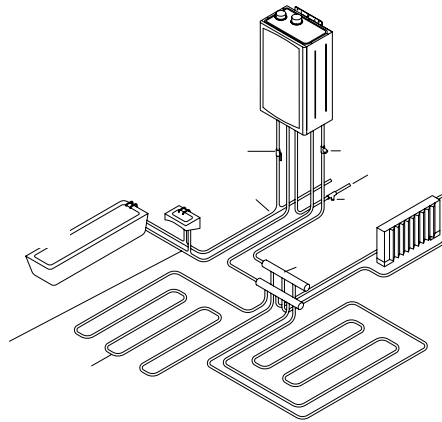

25K

( )

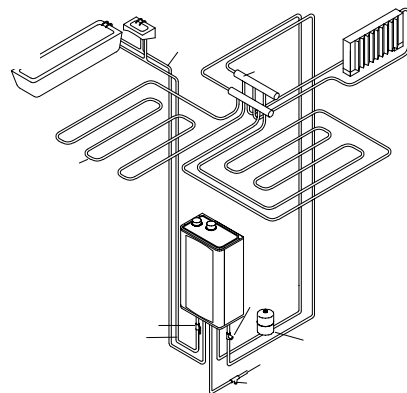

2,5 / 2.

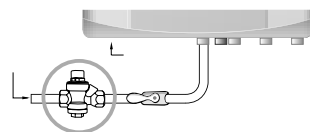

Kiturami



25

15A (PT ½)

1/100 ~ 1/200



15A (PT 1/2)



20A (PF 3/4).

36

44



$$A = Q \times 0.6 \times K \times P$$

A: (mm<sup>2</sup>)  
Q: ( / )  
K: [ 1]  
F: [ 2]  
P: (mm<sup>2</sup>)

1 -

1.0	1.3	1.4
-----	-----	-----

[ 2]

	1	2	3	4	5	6	7	8	9	10	11	12	13	14	15	16	17	18	19	20	21
(F)	1.00	1.00	1.00	0.95	0.92	0.89	0.86	0.84	0.82	0.81	0.80	0.80	0.80	0.79	0.79	0.78	0.78	0.77	0.76	0.76	0.75

1:1.4

W:D

2

MOCIE, 08. 1998.



Kiturami

1

1.2 ~ 1.5

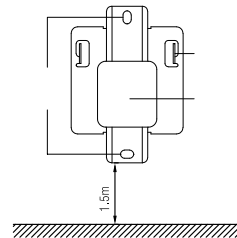

2

(CTR-5700PLUS).

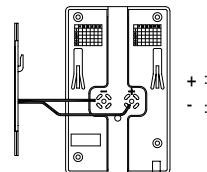

3

(CTR-5700PLUS)

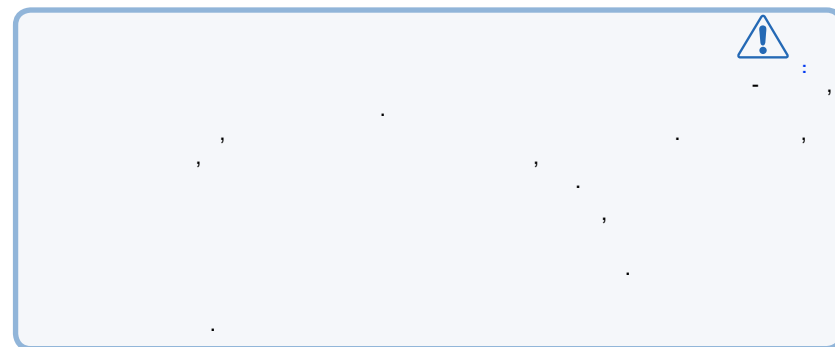
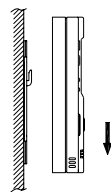

Kiturami



230 /50 ?









Kiturami

Kiturami



Kiturami

Kiturami